



**DAN JOHNSON**  
DIRECTOR

DEPARTMENT OF TRANSPORTATION AND DEVELOPMENT  
DEVELOPMENT SERVICES BUILDING  
150 BEAVERCREEK ROAD OREGON CITY, OR 97045

October 16, 2025

BCC Agenda Date/Item: \_\_\_\_\_

Board of County Commissioners  
Clackamas County

**Approval of a Board Order transferring jurisdiction over a portion of S Beaver Creek Road to the City of Oregon City. Order includes a one-time payment to the City of Oregon City of \$997,000. Funding is through Community Road Fund. No County General Funds are involved.**

<b>Previous Board Action/Review</b>	6/18/2025: Approval of Intergovernmental Agreement		
<b>Performance Clackamas</b>	1. Public trust in good government		
<b>Counsel Review</b>	Yes	<b>Procurement Review</b>	No
<b>Contact Person</b>	Mike Bezner	<b>Contact Phone</b>	503-742-4651

**EXECUTIVE SUMMARY:** There are certain county roads, such as S Beaver Creek Road in Oregon City, that are wholly, mostly, or partially within various cities throughout Clackamas County. Fragmented jurisdiction over these roads often results in differing road maintenance activities and confusion by the public as to which agency is responsible for the operation and maintenance of the roads.

On June 18, 2025, Clackamas County and the City of Oregon City entered into an intergovernmental agreement for the jurisdictional transfer of a portion of S Beaver Creek Road with the intent of streamlining planned roadway improvements, eliminating confusions to the public, and improving the efficiencies of maintenance and public service. This portion of S Beaver Creek Road is located entirely within Oregon City city limits.

Under the agreement, the County will to provide funds to the City in the amount of \$997,000, which is equal to the cost of a 2" asphalt overlay, the cost of replacement of 21 sidewalk ramps to comply with current Americans with Disabilities Act standards, and the cost of signal upgrades at S Maple Lane Road, in exchange for the City assuming exclusive jurisdiction over the portion of S Beaver Creek Road, containing approximately 799,800 square feet of right-of-way. By accepting jurisdiction, the City becomes the "Road Authority" responsible for all maintenance, improvements, permitting, and road standard activities.

**RECOMMENDATION:** Staff requests that the Board approve the attached Board Order transferring jurisdiction over a portion of S Beaver Creek Road.

Respectfully submitted,

*Dan Johnson*

Dan Johnson, Director  
Department of Transportation and Development

For Filing Use Only

# BEFORE THE BOARD OF COUNTY COMMISSIONERS

## OF CLACKAMAS COUNTY, STATE OF OREGON

In the Matter of Transferring Jurisdiction over  
a Portion of S Beavercreek Road to the City  
of Oregon City



Board Order No.

*Page 1 of 2*

**Whereas**, ORS 373.270 provides a mechanism for a county to surrender jurisdiction over a county road within a city to the city, provided the city requests or accepts such jurisdiction; and

**Whereas**, S Beavercreek Road, currently labeled as County Road No. 1227 and DTD No. 52033, is a county road, as defined in ORS 358.001; and

**Whereas**, the portion of S Beavercreek Road described in Exhibit “A” and depicted in Exhibit “B” attached hereto and incorporated herein (“S Beavercreek Road”) has been within the City of Oregon City’s jurisdictional boundary since 2008, with annexation caused by land use file AN-07-02; and

**Whereas**, on June 18, 2025, the County and the City entered into an Intergovernmental Agreement related to the transfer of S Beavercreek Road; and

**Whereas**, the Intergovernmental Agreement provides that, once the City completes the process to request jurisdiction over S Beavercreek Road, the County shall give notice and carry out the procedures set forth in ORS 373.270 to determine whether it is necessary, expedient, or for the best interests of the County to surrender such jurisdiction and, if so, to adopt an order surrendering such jurisdiction; and

**Whereas**, on August 20, 2025, the City adopted Resolution No. 25-22, requesting the surrender of such jurisdiction; and

**Whereas**, on 09/17/25, 09/24/25, 10/01/25 and 10/08/25, the County published notice of a hearing on this matter in the Lake Oswego Review; and

**Whereas**, on October 16, 2025, a hearing was held before the Clackamas County Board of Commissioners; and

**Whereas**, the Clackamas County Board of Commissioners deems it necessary, expedient, and for the best interest of the County to surrender jurisdiction over S Beavercreek Road;

\\

\\

\\

\\

\\

**BEFORE THE BOARD OF COUNTY COMMISSIONERS**

**OF CLACKAMAS COUNTY, STATE OF OREGON**

In the Matter of Transferring Jurisdiction over  
a Portion of S Beavercreek Road to the City  
of Oregon City



Board Order No.

*Page 2 of 2*

**NOW, THEREFORE, the Clackamas County Board of Commissioners does hereby order as follows:**

- Section 1:** Jurisdiction by the County over S Beavercreek Road is surrendered to the City pursuant to ORS 373.270.
- Section 2:** S Beavercreek Road shall be removed from the County's Road Inventory.
- Section 3:** Copies of this order shall be submitted to the Clackamas County Clerk's office for recording, and copies shall be subsequently sent without charge to the Clackamas County Surveyor, Tax Assessor, Finance/Fixed Asset Offices, and DTD Engineering.

**DATED** this 16th day of October 2025

**BOARD OF COUNTY COMMISSIONERS**

---

Chair

---

Recording Secretary

## Exhibit "A"

### S Beavercreek Road Transfer of Jurisdiction

### Clackamas County to City of Oregon City

#### Description

All of that portion of S Beavercreek Road, County Road No. 1227, Market Road 11, Resolution Road 1227, CR 238 and CR 337, Department of Transportation and Development Maintenance No. 52033; Situated in the NW 1/4 of Section 15, the SW 1/4 Section 10, the SE 1/4, NE 1/4 and NW 1/4 of Section 9, the SW 1/4 of Section 4, and the SE 1/4 Section 5, T. 3 S., R. 2 E., W.M., lying northwesterly of the southerly limits of Oregon City, said point also being (mile point 13.53) and east of the easterly right-of-way of State Highway 213, (mile point 15.31), as shown on Exhibit "B", attached hereto, and by this reference a part hereof. Total length being approximately 9,398 feet long.

Contains 799,800 square feet, more or less.

# EXHIBIT "B"

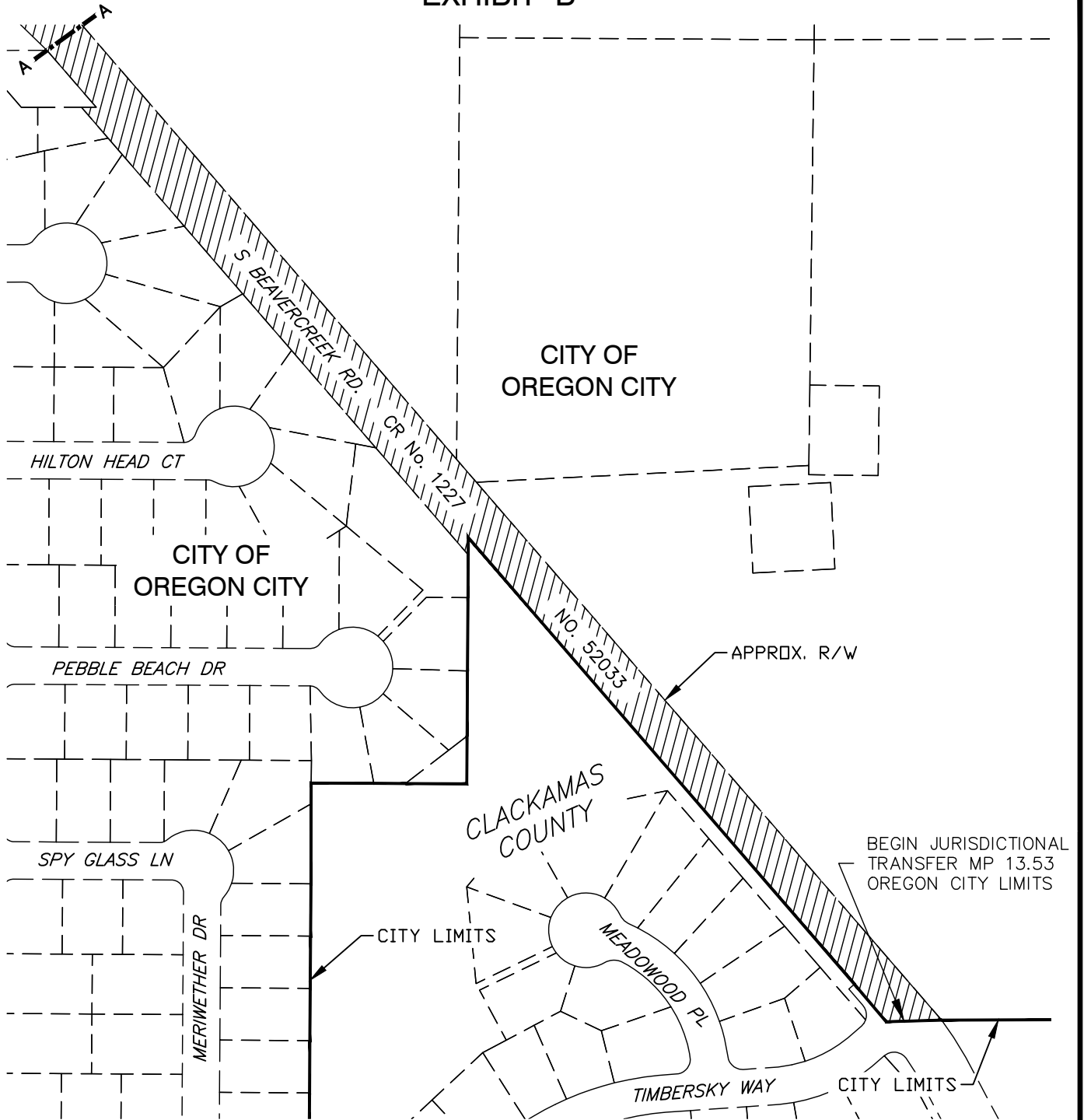

## LEGEND



TRANSFERRED AREA  
799,800 Sq. Ft.

LOCATED IN THE NE 1/4 OF SECTION 15 AND THE SW 1/4 OF SECTION 10, SECTION 9 AND THE SW 1/4 OF SECTION 4

T. 3 S., R. 2 E., W.M.

CLACKAMAS COUNTY, OREGON



PLAN  
1"=200'

DEPARTMENT OF TRANSPORTATION  
AND DEVELOPMENT

150 BEAVERCREEK ROAD  
OREGON CITY, OR 97045



BY: R. MAXWELL

DATE: 3/19/2025

JURISDICTIONAL TRANSFER  
S BEAVERCREEK ROAD  
COUNTY ROAD NO. 1227

SHEET

1 OF 6

# EXHIBIT "B"

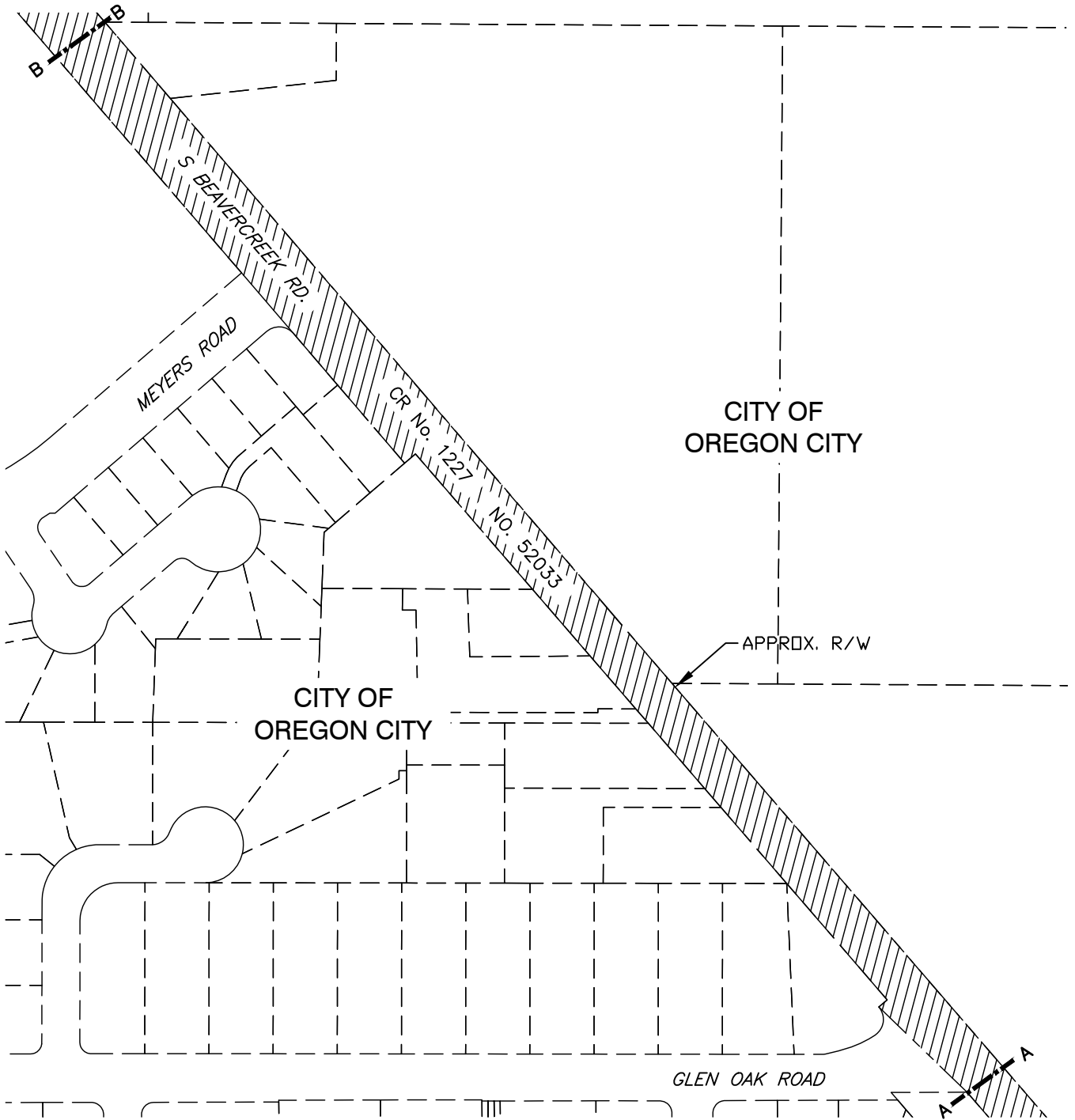

## LEGEND



TRANSFERRED AREA  
799,800 Sq. Ft.

LOCATED IN THE NE 1/4 OF SECTION 15 AND THE SW 1/4 OF  
SECTION 10, SECTION 9 AND THE SW 1/4 OF SECTION 4

T. 3 S., R. 2 E., W.M.

CLACKAMAS COUNTY, OREGON



PLAN  
1"=200'

DEPARTMENT OF TRANSPORTATION  
AND DEVELOPMENT

150 BEAVERCREEK ROAD  
OREGON CITY, OR 97045



BY: R. MAXWELL

DATE: 3/19/2025

JURISDICTIONAL TRANSFER  
S BEAVERCREEK ROAD  
COUNTY ROAD NO. 1227

SHEET

2 OF 6

# EXHIBIT "B"

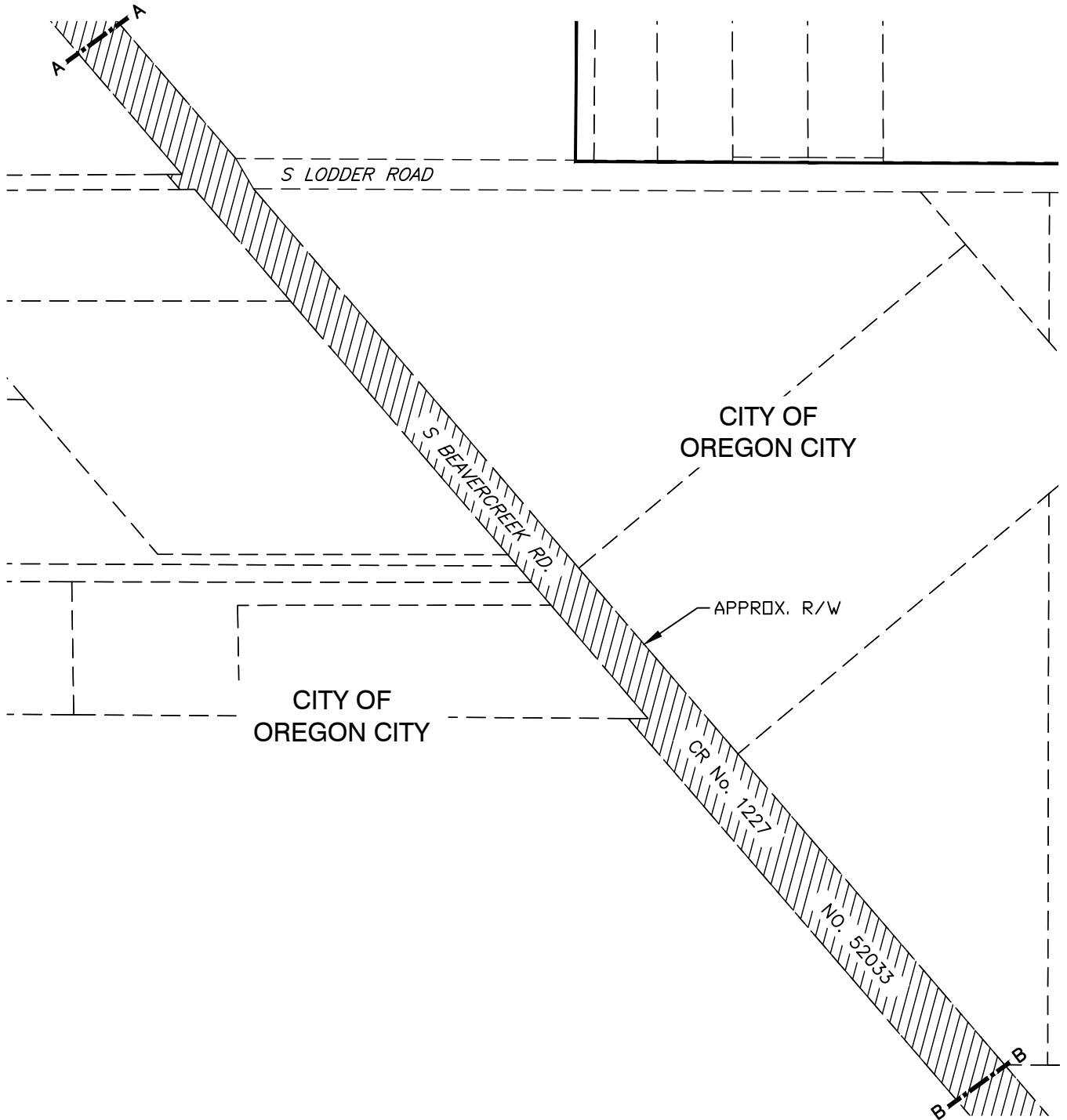

## LEGEND



TRANSFERRED AREA  
799,800 Sq. Ft.

LOCATED IN THE NE 1/4 OF SECTION 15 AND THE SW 1/4 OF  
SECTION 10, SECTION 9 AND THE SW 1/4 OF SECTION 4

T. 3 S., R. 2 E., W.M.

CLACKAMAS COUNTY, OREGON



PLAN  
1"=200'

DEPARTMENT OF TRANSPORTATION  
AND DEVELOPMENT

150 BEAVERCREEK ROAD  
OREGON CITY, OR 97045



BY: R. MAXWELL

DATE: 3/19/2025

JURISDICTIONAL TRANSFER  
S BEAVERCREEK ROAD  
COUNTY ROAD NO. 1227

SHEET

3 OF 6

# EXHIBIT "B"

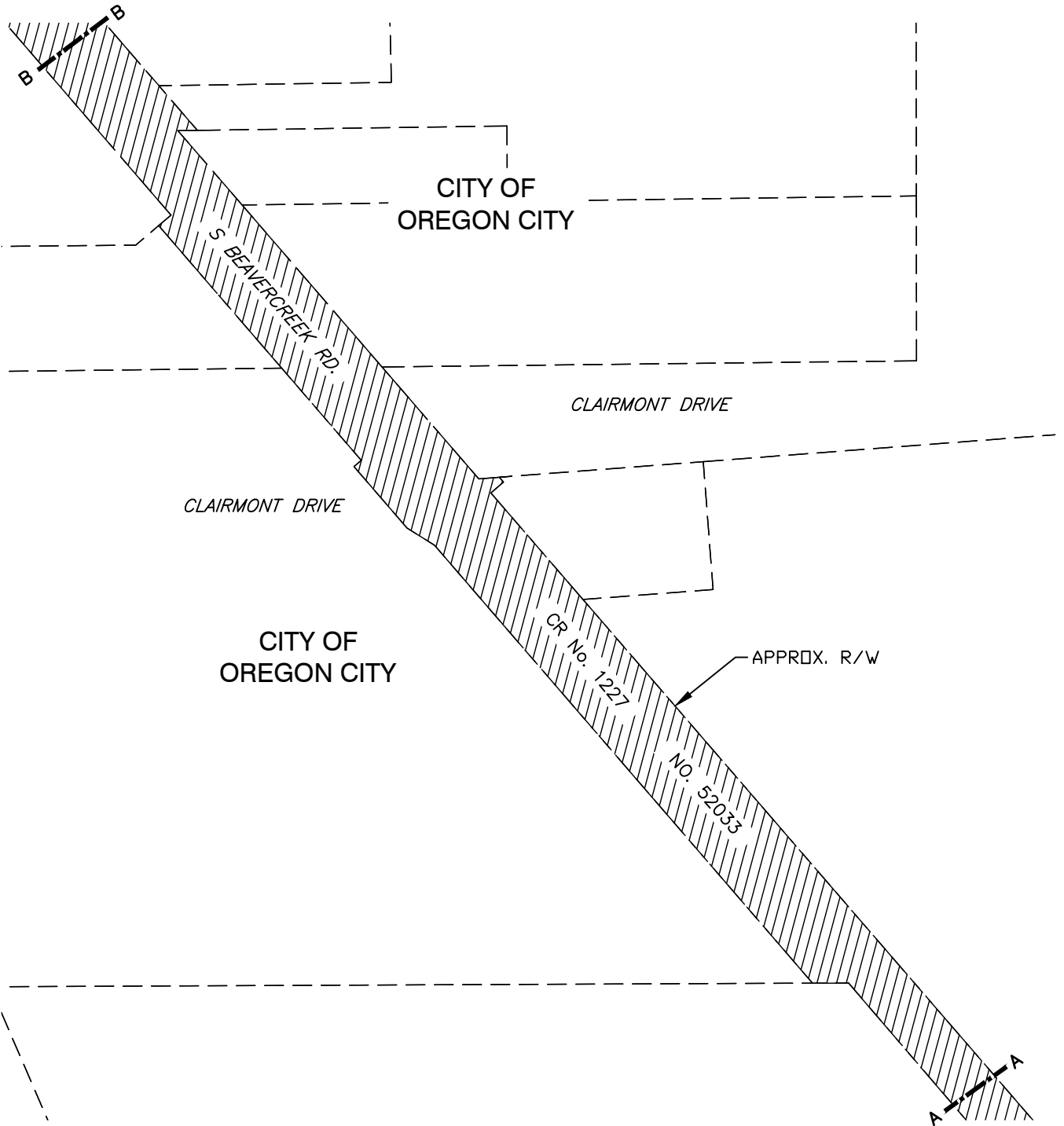

## LEGEND



TRANSFERRED AREA  
799,800 Sq. Ft.

LOCATED IN THE NE 1/4 OF SECTION 15 AND THE SW 1/4 OF  
SECTION 10, SECTION 9 AND THE SW 1/4 OF SECTION 4

T. 3 S., R. 2 E., W.M.

CLACKAMAS COUNTY, OREGON



PLAN  
1"=200'

DEPARTMENT OF TRANSPORTATION  
AND DEVELOPMENT

150 BEAVERCREEK ROAD  
OREGON CITY, OR 97045



BY: R. MAXWELL

DATE: 3/19/2025

JURISDICTIONAL TRANSFER  
S BEAVERCREEK ROAD  
COUNTY ROAD NO. 1227

SHEET

4 OF 6



# EXHIBIT "B"

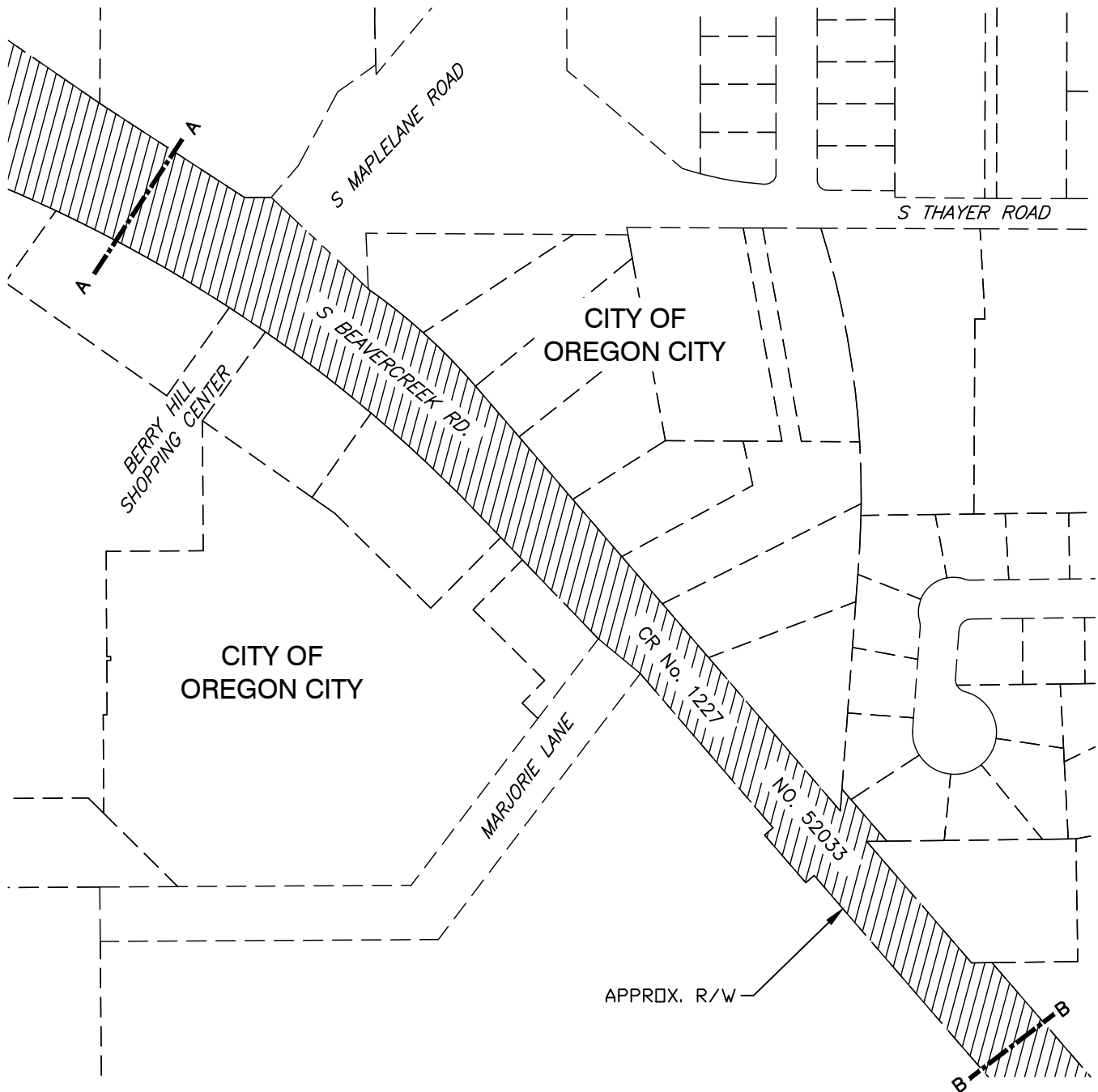

## LEGEND



TRANSFERRED AREA  
799,800 Sq. Ft.

LOCATED IN THE NE 1/4 OF SECTION 15 AND THE SW 1/4 OF  
SECTION 10, SECTION 9 AND THE SW 1/4 OF SECTION 4  
T. 3 S., R. 2 E., W.M.

CLACKAMAS COUNTY, OREGON



PLAN  
1"=200'

DEPARTMENT OF TRANSPORTATION  
AND DEVELOPMENT  
150 BEAVERCREEK ROAD  
OREGON CITY, OR 97045



BY: R. MAXWELL DATE: 3/19/2025  
JURISDICTIONAL TRANSFER  
S BEAVERCREEK ROAD  
COUNTY ROAD NO. 1227

SHEET  
5 OF 6

# EXHIBIT "B"

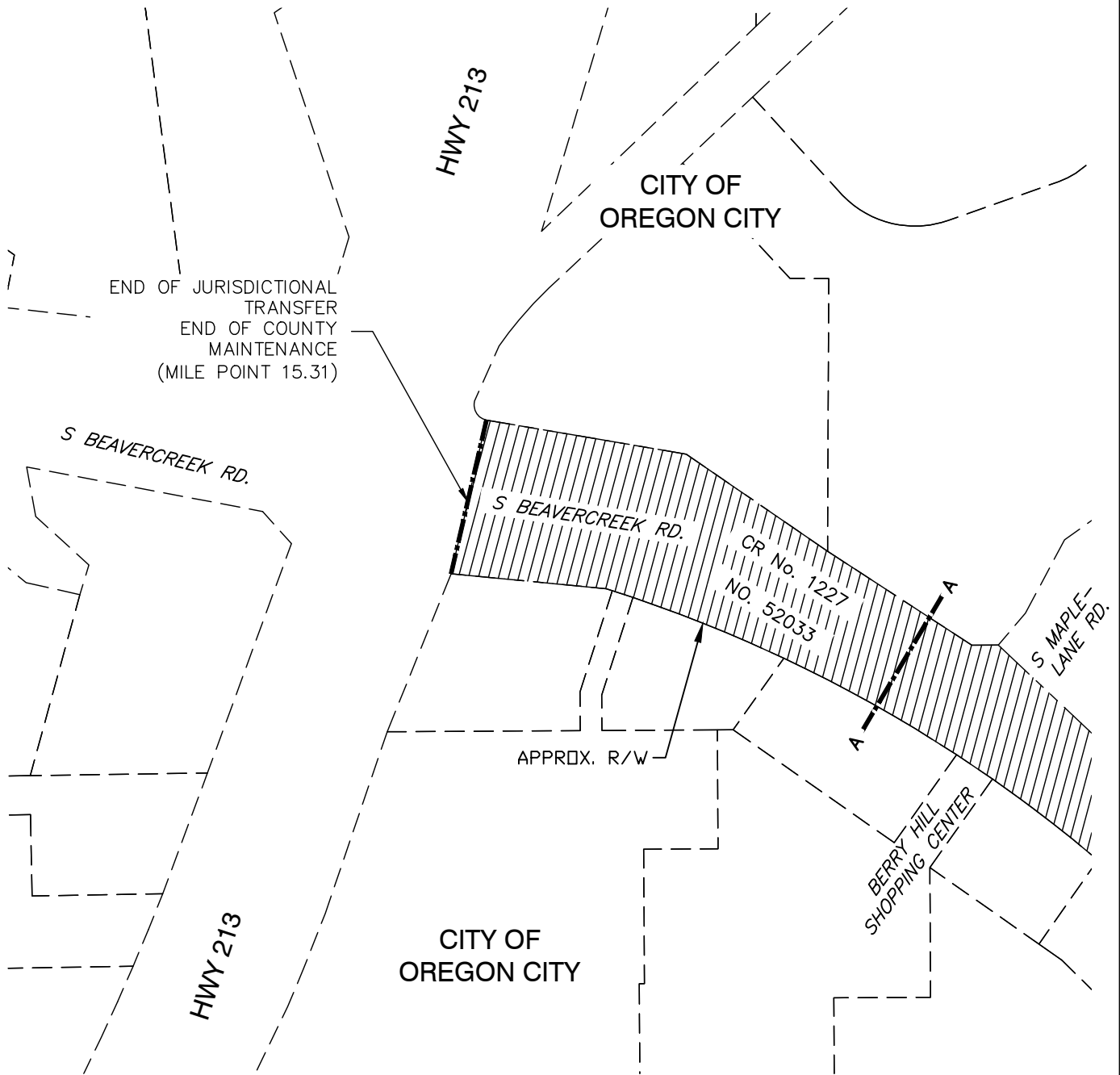

## LEGEND



TRANSFERRED AREA  
799,800 Sq. Ft.

LOCATED IN THE NE 1/4 OF SECTION 15 AND THE SW 1/4 OF  
SECTION 10, SECTION 9 AND THE SW 1/4 OF SECTION 4  
T. 3 S., R. 2 E., W.M.

CLACKAMAS COUNTY, OREGON



PLAN  
1"=200'

DEPARTMENT OF TRANSPORTATION  
AND DEVELOPMENT

150 BEAVERCREEK ROAD  
OREGON CITY, OR 97045



BY: R. MAXWELL

DATE: 3/19/2025

JURISDICTIONAL TRANSFER  
S BEAVERCREEK ROAD  
COUNTY ROAD NO. 1227

SHEET

6 OF 6